

IT-ES3012G-IU-4GS

8-port 10/100/1000Base-T(X) + 4-port 1000Base-SFP (optional)

Full Gigabit Unmanaged Industrial Ethernet Switch

Features

- Supports IEEE802.3, IEEE802.3u, IEEE802.3z/ab
- Supports 8 10/100/1000Base-T(X) RJ45 Ethernet ports
- Supports 4 1000Base-SFP fiber ports (optional)
- Supports MAC address auto-learning, auto-aging
- Supports 8K MAC address
- Supports 24Gbps backboard bandwidth
- Supports redundancy DC power supply (12 ~ 48VDC)
- Supports 1 channel relay alarm output
- Industrial grade 4 design, -40-75°C working temperature
- IP40 protection grade, DIN-Rail mounting



Introduction

The IT-ES3012G-IU-4GS series switches are high-performance, cost-effective, industrial-grade unmanaged Ethernet switches designed for the power industry. These switches support 8 10/100/1000Base-T(X) Ethernet ports and 4 1000Base-SFP slots (optional). All RJ45 Ethernet ports of switches support automatic flow control, full/half duplex mode and MDI / MDI-X adaptation.

Products with fanless, low power design, work performance more stable. Products meet the FCC, CE standards, -40 ~ 75 °C operating temperature range to adapt to the harsh working environment, all components are selected industrial grade, to achieve a high reliability, for the power industry users Ethernet device connection Provide a reliable, economical solution.

Specification

Technology

Standard: IEEE802.3, IEEE802.3u, IEEE802.3z/ab

Exchange attribute

100M forward speed: 148810pps

1000M forward speed: 1488100pps

Transmit mode: store and forward

System exchange bandwidth: 24G

MAC address table: 8K

Memory: 4Mbit

Interface

Gigabit RJ45 port: 10/100 /1000Base-T(X) auto speed control, Half/full duplex and MDI/MDI-X auto detect

Gigabit SFP port: 1000Base-X, SFP slots

Console port: Reserved

Alarm port: 2-pin 7.62mm spacing terminal block

1 channel relay alarm output

Transfer distance

Twisted cable: 100M (standard CAT5/CAT5e cable)

Multi-mode: 1310nm, 2Km

Single-mode: 1310nm, 20/40Km

1550nm, 60/80/100/120Km

LED indicator

Run indicator: RUN

Interface indicator: Link (G1~G8/G12)

Power supply indicator: P1, P2

Alarm indicator: ALARM

Power supply

Input Voltage: 12 ~ 48VDC

Type of input: 4-pin 7.62mm spacing terminal block

DC support reverse connection

DC support redundant power supply

Intellisystem Technologies S.r.l.

Via Augusto Murri, 1 - 96100 Siracusa - Phone +39 (0)931-1756256 / +39 (0)2-87167549 - Mobile (+39) 335 1880035

em@il: info@intellisystem.it WEB: <http://www.intellisystem.it>

Consumption

➤ IT-ES3012G-IU-4GS

No-load consumption: 4.85W@24VDC

Full-load consumption: 10.32W@24VDC

Working environment

Working temperature: -40 ~ 75 °C

Storage temperature: -40 ~ 85 °C

Relative Humidity: 5%~95 % (no condensation)

Mechanical Structure

Shell: IP40 protect grade, metal shell

Installation: DIN-Rail mounts

Weight: 960g

Size (WxHxD): 70mmx160mmx130mm

Industry Standard

EMI: FCC Part 15, CISPR (EN55022) class A

EMS: IEC 61000-4-2 (ESD), Level 4

IEC 61000-4-4 (EFT), Level 4

IEC 61000-4-5 (Surge), Level 4

Shock: IEC 60068-2-27

Free fall: IEC 60068-2-32

Vibration: IEC 60068-2-6

Certification

CE, FCC, RoHS, UL508 (Pending)

Warranty: 5 years

Dimension (Unit: mm)

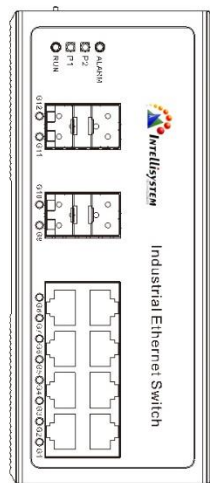

IT-ES3012G-IU-4GS

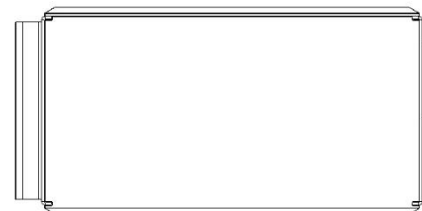
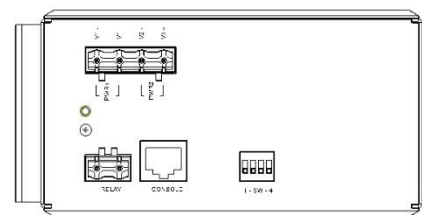
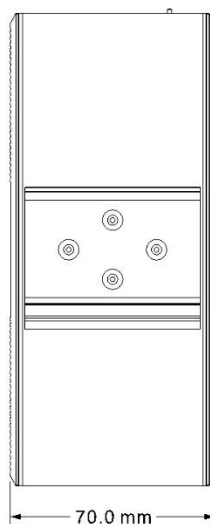
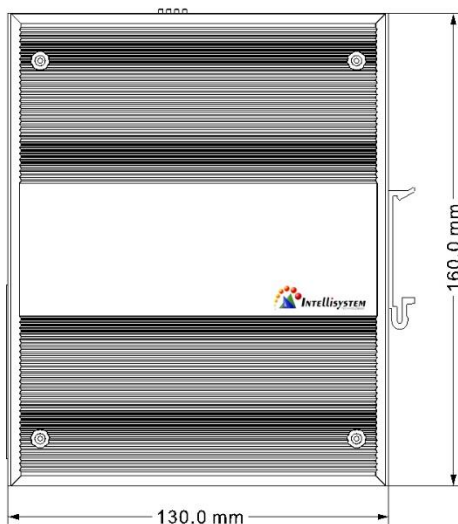

Ordering Information

Available Models	Port Interface		Power Supply
Standard Models	1000Base-X	10/100/1000Base-T(X)	12~48VDC
IT-ES3012G-IU-4GS	4	8	

Packing List

1. Industrial Ethernet Switch (plus terminal block) x 1
2. User manual x 1
3. Certificate of quality x 1
4. Warranty card x 1
5. DIN-Rail mounting kit x 1