

# IT-SSL500-IRL

Adopt with innovating homogenization laser technology, IT-SSL500-IRL has even IR light spot. Equipped with high power IR laser tube for 300m/500m IR distance and excellent quality of electric zooming lens of 1-60° adjustable angle, the product can be flexible installed for many kinds of occasions. With a standard interface parameters, it's compatible with the industry general protocol Pelco-D and Sony VISCA. In the process of beam angle adjustment, user can set the preset position for calling to control the beam angle of laser automatically to the set point of view. It is the ideal infrared lighting source for night vision CCTV/IP cameras.



## Product Features

- Photoelectric conversion efficiency reach to 40%
- Smooth electric synchronous zoom from 1° to 60°
- Life span is 50,000hrs
- homogenized light spot with no noise
- RS485 interface
- Coaxial lens focus, sync. with camera
- Power lose memories
- Preset position
- Low heating, high efficiency

## Application

- Forest Fire Prevention
- Oil well monitoring system
- Public security system
- Traffic speed measurement

## Real Picture



Day



Night



IR OFF



IR ON

## Technical Specification

Parameter	Parameter Value	
<b>Model</b>	<b>IT-SSL500-IRL</b>	
<b>Laser Mode</b>	Multi-mode	
<b>Wavelength</b>	808±10nm	
<b>Optical Power</b>	3W	
<b>Illumination Angle</b>	1°-60° adjustable	
<b>Beam Shape</b>	Round	
<b>Beam Diameter</b>	5m diameter with 1° at 300m	8m diameter with 1° at 500m
<b>Beam Spot Uniformity</b>	Good	
<b>Viewing Distance</b>	500m	
<b>Operating Voltage</b>	DC12V	
<b>Operating Current</b>	1.8A	
<b>Service Life</b>	50000h	
<b>Operating Temperature</b>	-40°C to +60°C	
<b>Storage Temperature</b>	-40°C to +85°C	
<b>Power Consumption</b>	<22W	
<b>Dimension</b>	L156*W90*H159mm	
<b>Material</b>	Aluminium Alloy	
<b>Color</b>	Black color	
<b>Total weight</b>	1.65kg	
<b>Laser Protection</b>	2M	

## Dimension

Unit: mm

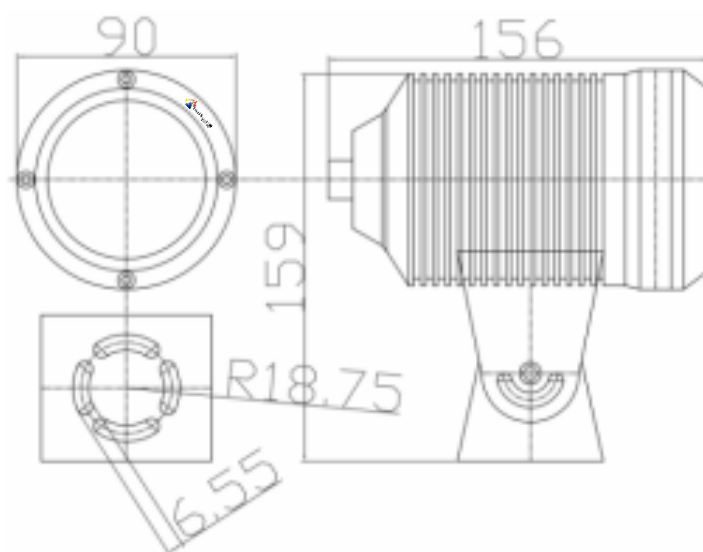

## Interface Connection

Power Line- Anode	Red & Orange DC12V+	
Power Line-Cathode	Black & White DC12V-	
Control Line A	Yellow RS485+	
Control Line B	Green RS485-	
Control Line- Cathode	White	
Communication Interface	RS485	

## RS485 Interface Control Instructions

Speed dome keyboard control

Speed dome keyboard control & communication protocol: General Pelco-D

Speed Dome Keyboard	Function	Coding
254-SHOT-ACK	Laser Power On	81 01 04 00 02 FF
255-SHOT-ACK	Laser Power Off	81 01 04 00 03 FF
TELE	Zoom Up	81 01 04 07 27 FF
WIDE	Zoom Down	81 01 04 07 37 FF
	Zoom Off	81 01 04 07 00 FF
	Electrical Machine Speed Setup	81 01 05 P1 P2 FF (P1-High order, P2- Low order, Range ≤60000)



Speed Dome Keyboard

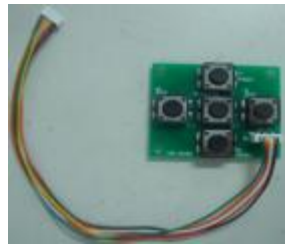

Tips: We suggest using Speed Dome Keyboard preferentially to control the IR laser light! In case you don't have one you can use the small keyboard we supplied!

## Small keyboard Control

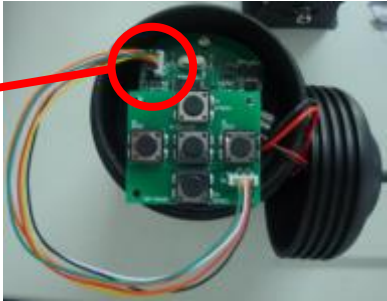
Button	Function	Small key board 
K1	Zoom Up	
K2	Zoom Down	
K3	Electrical Machine Speed Up	
K4	Laser On/ Off	
K5	Electrical Machine Speed Down	

<p>1. Twist out the rear cover when adjust the Keyboard.(Anti-clockwise Direction)</p> <p>*Main board Keyboard Cable Interface 1.25MM*6P</p>	
<p>2. After the adjustable of laser light adjustable, tighten the rear cover.</p>	

## Laser Safety Instruction

Laser safety mark and requirements

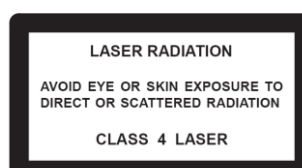



### ■ S-S500L laser class:

According to 21 CFR 1040.10 or IEC60825-1:2007 standard, the safety level of this product is Class 2 high power strong laser equipment. Output laser light with 800-1000nm, 3W power. This level of power is safety to human eye, the output radiation is invisible light. Direct or scattering laser light is harmful to human eye. Laser protective glasses is not the product standard accessories, but during the process of operation must correctly wear the laser protective glasses.

- S-S500L IR laser light is a light sources, to be integrated with other equipment by user. The user will be responsible for the integrated products.
- S-S500L laser emission power is 3W including visible and invisible ray, wavelength is 800-1000nm.
- It is prohibited to move or re-install the output colimation under the laser light is power on.

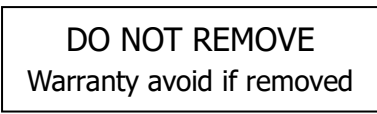
### ■ Laser warning mark

Mark	Instruction	Position
	If this warranty label is damaged / removed the product cannot be repaired.	On the upper cover of the case
	Laser radiation warning sign	On the upper cover of the case
	Warning label	On the upper cover or front cover of the case

All products, product specifications and data are subject to change without notice.