

IT-SS30D-IRL 20X

- ✓ *Zoom Laser IP Camera*
- ✓ *20X optical zoom 2MP Network camera with built-in vafi-angle IR laser light for effective up to 300m IR distance. It has H.264/MJPEG video compression and configurable dual stream outputs.*
- ✓ *Equipped with a 2MP HD sensor enabling viewing resolution of 1920x1080 at a smooth 25/30 fps.*
- ✓ *Designed for 24hours long range outdoor IP video surveillance applications.*



Product Features

- Base on Amarelle A5S66 video processor, adopted with Linux embedded OS, low power and stable and safety
- 2Megapixel HD 1/2.8" CMOS Sensor
- H.264/MJPEG video compression, high compression ratio, good image quality; Support for dynamic bit rate control
- Support 1080P/720P/D1/CIF/QCIF, complicated output by the main stream and alternate stream
- Digital WDR for clear visibility
- Network adaptive technology, according to the network bandwidth automatically adjust the frame rate of video transmission
- Low bit rate
- 20X Optical Zoom 4.7-94 mm (F1.6 to 3.5)
- Clear picture 30 fps @ 1920x1080
- Auto focus, Electric shutter, day/night(ICR), AWB, AGC, BLC
- DNR (2D+3D)
- 3D positioning
- Built-in IR laser light sync. vari-angle, effective up to 300m
- Weather-proof IP66-rated and working Temperature -40°Cto +60°C

Application

Recommended for long range HD IP video surveillance at highway, port, railway system, border, prison, safety city, school, fire prevention and all kinds of industries installations.

Laser Safety Instructions

According to GB7247.1-2012 or IEC60825-1:2007 *Safety of Laser Products - Part 1: Equipment classification and requirements*, the safety level of the product is Class 1.

Dimension

Unit: mm

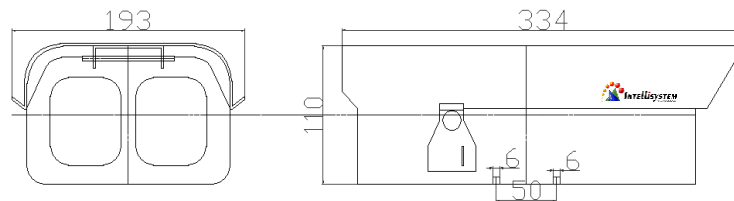

Technical Specification

Image Sensor		1/2.8" 2megapixels Progressive Exmor CMOS
Effective Pixels		1920(H) ×1080(V)
Resolution		Preferred Stream: 1920*1080(25fps/30fps) Alternate Stream: 720*576(25fps/30fps)
Video Output		Network Output
S/N Ratio		≥50dB (AGC Off, Weight ON)
Min. Illumination		Color: 0.05Lux@F1.6 B/W: 0.005Lux@F1.6
Back Light Compensation		On/Off
Wide Dynamic		Support
Day/Night		Auto (ICR) / Manual
IR	Wavelength	808nm±10nm
	Distance	Effective distance ≤300m
	Angle	Electric synchronous zooming 1-60°
Sync.	Scanning System	Progressive
	Synchronization	Inter-sync
Auto Gain Control		Support
White Balance		Auto/Manual/Trace/Outdoor/Indoor/Outdoor auto/Sodium Lamp Auto/Cadmium Lamp
Electronics Shutter		Auto (1/25~1/10,000 s) , Manual (1/5~1/10,000 s)
2D Noise Reduction		Support
3D Noise Reduction		Support
Rollover		Support
Video Compression		H.264/MJPEG
Protocol		IPv4/IPv6, HTTP, Qos, FTP, SMTP, UPnP, SNMP, NS, DDNS, NTP, RTSP, RTP, TCP, UDP, ICMP, DHCP, PPPoE, onvif, 28181
Multibit Stream		Dual Stream, Stream Range
Outer Control		RS232, Baud rate support 9600, 19200, 38400bps, 1 stop bit
Interface		PELCO-D, CW-Protocol
Focus		Auto/Manual/Auto Focus One Time
Zoom Speed		4s
Lens Initialization		Built in
Exposure Compensation		Support
Slow AE		Support
Gain Settings		Support
IRIS Control		Auto/Manual
Focus Control		Auto/Manual
Digital Zoom		Support
OSD		Code rate, frame rate data, time, title, 5 custom text line and multiple fonts and sizes optional
TF Card		Support
Analog Video		Support
Voice Intercom		Support

Alarm		2 channels input, 1 channel output
Working Environment		-20°C ~ +60°C < 80% RH
Optics	Optical Zoom	20X, 4.7 - 94mm (F1.6 to F3.5)
	Minimum Focus Distance	100mm - 800mm (Near Focus ~ Far Focus)
	Maximum Range Observed	HOR: 65.1° (Near Focus) to 2.34° (Far Focus)
Working Voltage		DC12V
Current		2A
N.W		2.2kg
Dimension (L*W*H)		L334mmxW193mmxH110mm

All products, product specifications and data are subject to change without notice.